

# NOISE ABATEMENT PROCEDURES FOR FLYING FRIENDLY

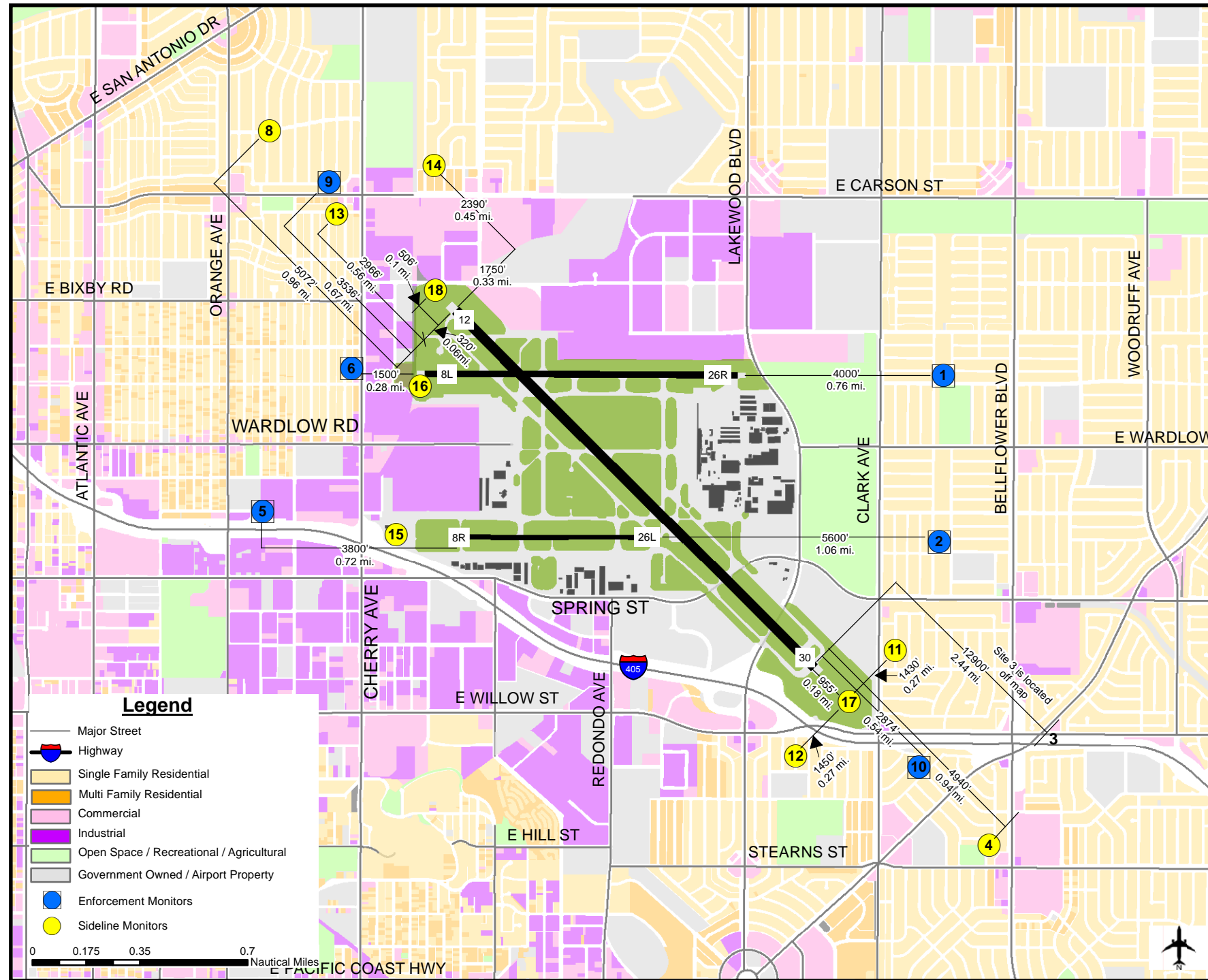

## The City of Long Beach Noise Compatibility Ordinance NO. C7320 Chapter 16.43

### Noise Limits

| Runway | 7:00 am - 10:00 pm SENEL (dBA) | 10:00 pm - 11:00 pm<br>6:00 am - 7:00 am<br>SENEL (dBA) | 11:00 pm - 6:00 am SENEL (dBA) | Monitor # |
|--------|--------------------------------|---|--------------------------------|-----------|
|        | Departure/Arrival              | Departure/Arrival                                       | Departure/Arrival              |           |
| 30     | 102.5/101.5                    | 90/90   | 79/79                          | 9 & 10    |
| 12     | 102.5/101.5                    | 90/90   | 79/79                          | 10 & 9    |
| 26R    | 92/88                          | -   | -                              | 6 & 1     |
| 26L    | 95/93                          | -   | -                              | 5 & 2     |
| 08R    | 95/92                          | -   | -                              | 2 & 5     |
| 08L    | 88/92                          | -   | -                              | 1 & 6     |

Time periods are enforced at the noise monitors, which are synchronized nightly to the atomic clock in Boulder, CO. SENEL (Single Event Noise Exposure Level) is a sound measurement in which the max decibel level and the duration are factored together logarithmically.

### Noise Abatement and Curfews

#### Runway Curfews

The only available runway between the hours of 10:00 pm and 7:00 am is Runway 30/12 unless notified per NOTAM or ATC.(check ATIS)

#### Training Operations

No touch-and-go, stop-and-go, practice low approach, or VFR practice missed approach shall be conducted at the Airport except between 7:00 am and 7:00 pm on weekdays, and between 8:00 am and 3:00 pm on weekends and holidays.

#### Engine Run-Ups

For purposes other than preflight, run-ups shall be permitted only between the hours of 7:00 am and 9:00 pm on weekdays, and 9:00 am and 9:00 pm on weekends and holidays, at locations approved by the Airport Manager.

#### Formation Takeoffs and Landings:

Formation Takeoffs and Landings are prohibited at Long Beach Municipal Airport.

#### Pattern operations

-The recommended pattern altitude is 1,000msl.

-Please fly your downwinds for RY25L about 1/2nm, but no farther than 3/4nm from the runway - large jet arrivals to RY30 will cross below the downwind.

### NOTES:

- SAFETY AND AIR TRAFFIC CONTROL INSTRUCTIONS ALWAYS TAKE PRECEDENCE.
- Please Fly Quietly and help maintain the quality of life in surrounding communities.
- Not intended for navigational purposes.

**LONG BEACH/DAUGHERTY FIELD/ (LGB)**

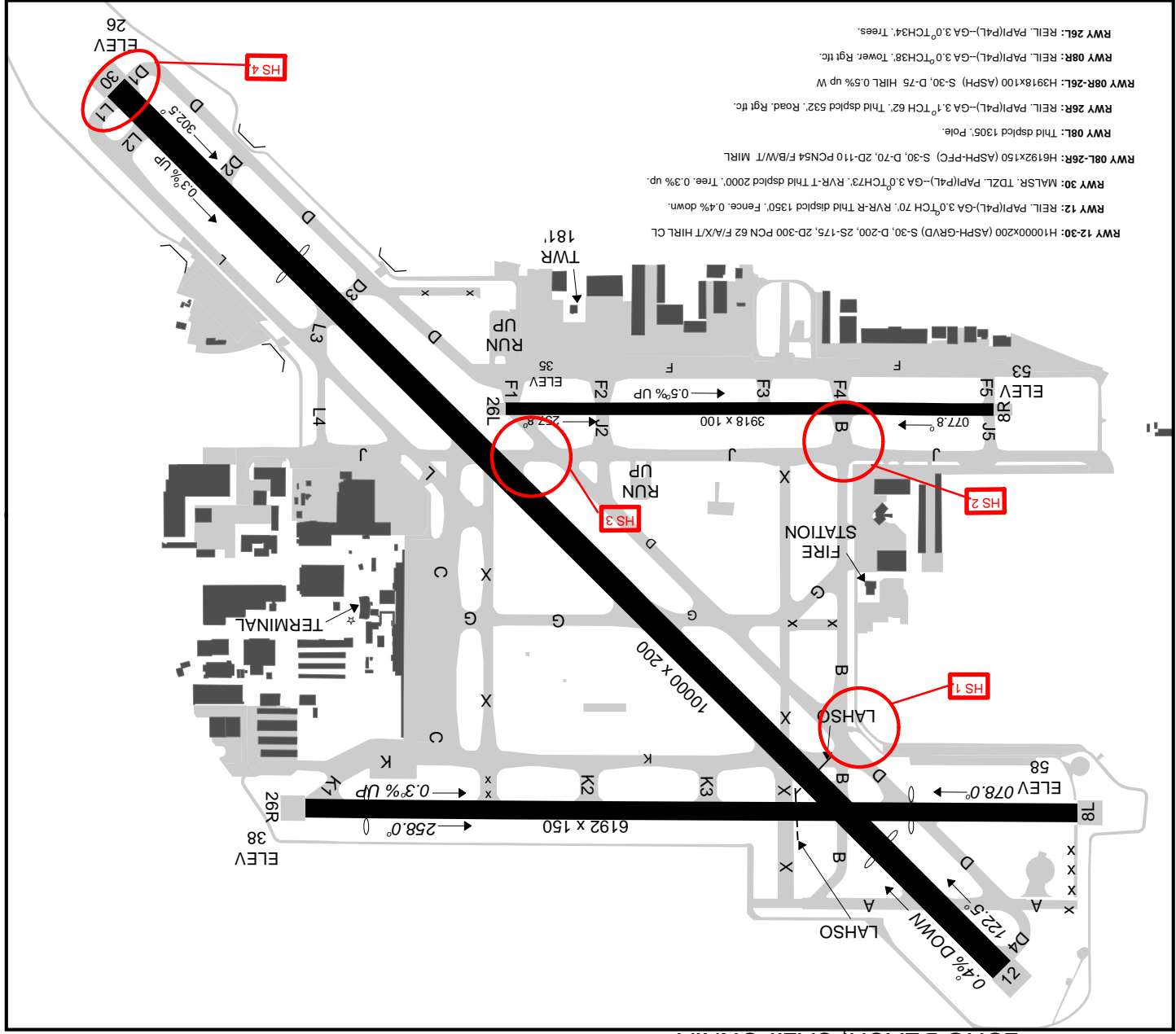

- HS 1** Act northbound on Twy B and instructed to hold short of Rwy 12/30 and Rwy 08L-26R. Rwy 12-30 and Rwy 08L-26R.
- HS 2** Act southbound on Twy B anticipate reaching their destination parking ramp and fail to hold short of Rwy 08R and 26L.
- HS 3** Act eastbound on Twy J and instructed to taxi to Rwy 26L at Twy D sometimes miss the turn onto Twy D and proceed onto Rwy 12-30 without authorization.
- HS 4** Act Idg Rwy 30, be aware that this Rwy crosses every other Rwy at the Arpt. When exiting, pilots should ensure the follow a yellow lead off line onto a Twy.



  
 where the going is easy.

4100 DONALD DOUGLAS DR  
 LONG BEACH, CA 90808  
 562-570-2600  
 www.longbeach.gov/lgb

**FREQUENCIES AND COMMUNICATIONS**

- CTAF: 119.4
- UNICOM: 122.95
- ATIS: 127.75
- WX ASOS: PHONE 562-424-0572
- LONG BEACH GROUND: 133.0 257.6 [0615-2345]
- LONG BEACH TOWER: 119.4; RWY 30 APCH, RWY 12 DEP 120.5; RWY 12 APCH, RWY 30 DEP 257.6 [0615-2345]
- SOCAL APPROACH: 125.35
- SOCAL DEPARTURE: 127.2
- CLEARANCE DELIVERY: 118.15
- ANAHEIM DP: 125.35; RWY 08L, 08R, 12, VENTURA TR 127.2; RWY 26L, 26R, 30, HECTOR, LAK 134.9; RWY 26L, 26R, 30, VENTURA TRA
- BAUBB STAR: 127.4
- DSNEE STAR: 134.0
- EMERG: 121.5 243.0
- FRITR DP: 125.35; RWY 12 127.2; RWY 26R, 30
- HAWWC DP: 125.35; RWY 08L, 08R, 12 134.9; RWY 26L, 26R, 30
- IC: 119.4; RWY 30 APCH, RWY 12 DEP 120.5; RWY 12 APCH, RWY 30 DEP 127.4
- PCIFC STAR: 127.4
- ROOBY STAR: 134.0
- TANDY STAR: 127.4
- TOPMM DP: 125.35; RWY 12 134.9; RWY 26L, 26R, 30
- VFR LAX CLASS B: 134.9
- ZOOMM DP: 125.35; RWY 12 127.2; RWY 26R, 30
- WX AWOS-3PT at CPM (6 nm NW): 127.150 (310-631-4958)
- WX ASOS at FUL (9 nm E): PHONE 714-870-1372
- WX ASOS at HHR (11 nm NW): PHONE 310-973-8930
- WX ASOS at LAX (15 nm NW): PHONE 310-568-1486
- WX ASOS at SNA (17 nm SE): PHONE 714-424-0590
- WX AWOS-3PT at EMT (17 nm N): 118.75 ((626) 444-1107)
- WX ASOS at SMO (19 nm NW): PHONE 310-392-6453